

ENGINEERING

EPCI

Since **1993**, more than **30 years** of expertise

A new eye on the industry



AIRCRAFT INTERIORS



The customized product of today is the standard of tomorrow!

EPCI Engineering is an industrial supplier with engineered solutions to fastening problems since 1993.

It's been 30 years now that EPCI Engineering offers a complete design service from concept, through prototypes, to final production by working closely with customers.

In addition to its own products developed in its applications areas, EPCI Engineering has selected a wide range of brands for specific and innovating technologies.

40% of EPCI Engineering products are customized and/or new products.
EPCI Engineering is a technical fastening solutions provider who propose, design and distribute:

- Standard products

- Adapted products from standard

- New products



Quick release fasteners

- JERGENS® - Fastening Solutions
- Locks
- Quarter turn fasteners
- Safety lock
- SLIC PINS® - Quick release pins
- Tension latches

Mechanical Fasteners

- Captive screws
- CUTWELL®
- SPIRALOCK® - Taps, nuts, wire thread inserts
- TANGLESS® - Wire inserts without tang
- Inserts for composite panels

Shielding RFI & Thermal Management products

- GAP fillers
- Microwave absorbers
- Shielding EMI, RFI
- Static sealing
- Thermally conductive insulator

Motion Control

- Gas springs
- Handles, locking systems
- Hinges
- Slides

Defense and Aerospace

- CRESCENT Manufacturing®
- HYDRAFLOW® - Hoses, couplings & quick disconnects
- VERNET®
- VOSS® - Clamps & flanges





Summary

Fluid Systems

- Lavatory / Galley	2 - 3
- Breathing oxygen	2 - 3
- Air supply	4 - 7

Motion Control

- Seat and screen motions	8 - 9
- Seat motions	10 - 11
- Cabine storage	12 - 13

Fasteners

- Aluminum seat structure	14 - 19
- Fixing seats	20 - 21
- Fixing seats and others	22 - 23



HYDRAFLOW

EXPERTISE IN LOW PRESSURE FLUID TRANSFER SOLUTIONS

HYDRAFLOW developed for fluid applications four lines of innovative, high quality products that meet current needs at low pressure.

HYDRAFLOW flexible fluid couplings, including clamshell, threaded, and spherical flange couplings, are used in military and commercial applications and have earned a reputation for superior quality and reliability.

The various types of **HYDRAFLOW** quick disconnects offer a no-compromise solution to classic quick disconnect complaints.

The wide range of **HYDRAFLOW** hose assemblies provides an unmatched combination of flexibility, strength, and lightweight design.

RANGE OF PRODUCTS



Fluid couplings

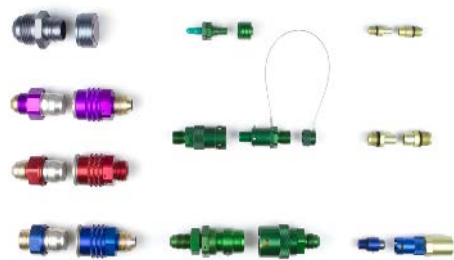

Quick disconnect



Hoses



Potable water manifold

Lavatory | Galley



Potable water

Couplings :

- Thread, Flared / Flareless
- Clam Shell (14J series), meet AS1650 specifications
- Quick Disconnect (5Q series), meet Airbus A380 specification

Our recommendation is the Quick Disconnect 5Q in term of easy to use, time/space/weight saving and integrated sealing

Hoses, heated or non-heated :

- HS 79 series - FAR 25.853 compliant
- Meets : AS4468 / Heated AS5420

Manifold / Fitting:

- FT series

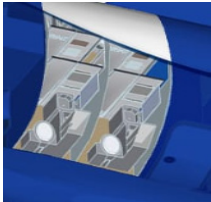

Drain

Couplings :

- Thread, Flared / Flareless
- Clam Shell (14J series), meet AS1650 specifications
- Quick Disconnect (5Q series), meet Airbus A380 specification

Our recommendation is the Quick Disconnect 5Q in term of easy to use, time/space/weight saving and integrated sealing

Hoses, heated or non-heated :

- HS 79 series - FAR 25.853 compliant
- Meets : AS4468 / Heated AS5420

Manifold / Fitting:

- FT series

Crew | Passenger

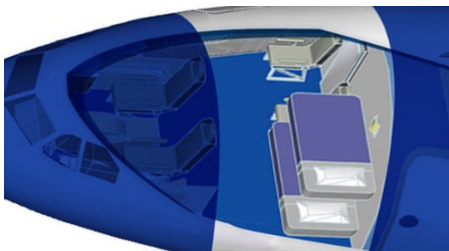

Replace your rigid system into a flexible one, especially on your medical liquid oxygen system.

Couplings :

- Thread, Flared / Flareless
- Quick Disconnect (5Q series), meet Airbus A380 specifications

Our recommendation is the Quick Disconnect 5Q in term of easy to use, time/space/weight saving and integrated sealing.

Hoses with anti kink spring :

- HS57 series, FAR 25.853 with an anti kink spring in order to operate with a tight bend radius, ensuring a steady flow of oxygen
- Meets B/E, Boeing, Douglas specifications

New added value products:



Swivel, allowing a degree of rotation to compensate for any bad angular position



Quick disconnect 5Q 90°



Heated sockets for junctions



Quick racking D4000 on Galley fridge drain (assured reliable shut off on disconnection) Meet AS4251

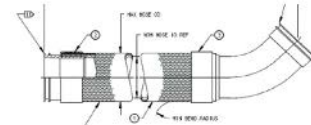

Drain lavatory waste water : 55158



MANUFACTURER OF ENGINEERED COMPOSITE STRUCTURES AND ASSEMBLIES

FLEXCO® has been a longtime supplier of complex non-metallic components to the aerospace industry.

Typical **FLEXCO®** parts include both rigid and flexible ducts, plenums, hoses, tubes, and other aircraft components.

FLEXCO® offers a wide range of aerospace-standard hoses and ducts, as well as build-to-print components.

With over 60 years of experience, **FLEXCO®** has become a leading producer of trapped-tool composites, utilizing both pourable plaster mandrels and complex breakdown tooling.

RIGID PRODUCTS:



- Ducts
- Plenums
- Housings
- Access Doors
- Flanges
- Brackets



- Fabrics including fiberglass, Kevlar, or carbon-fiber
- Resins including epoxy, phenolic, or polyamide



FLEXIBLE PRODUCTS



- Bellows
- Convoluted Ducts
- Wire-Reinforced Tubes
- Hoses
- Gaskets
- Seals
- Connectors

Aerospace standard parts include, but are not limited to AS1503, AS1504, AS1505, AS1506, AS1543, AS1544, AS4804, AS8796, BACD40A, BACD40B, BACD40D, BACD40J, BACD40K, C9601, GD10A, GH510, GS10A, LS1611, LS1611A, LS4486, LS4487, M6855/4, NAS520, NAS521, NAS1370-NAS1378, S1053K, S361, SCEET, ST7M367, and ST7M389.

FACILITY

- 14,000 SF of Manufacturing Space
- (3) Vacuum-Capable Ovens
 - 84" x 72" x 180" – up to 400°F
 - 72" x 72" x 72" – up to 750°F
 - 36" x 48" x 72" – up to 400°F
- On-Site Testing for Leakage, Pressure and Vacuum
- Heated Compression Mold Press
- 10oF and 40oF Raw Material Cold Storage
- Environmentally-Controlled Manufacturing Rooms
- Climate-Controlled Plaster Mandrel Storage

QUALITY

FLEXCO® is AS9100C/ISO9001: 2008 certified as well as Nadcap-certified for composites manufacturing. Flexco is also a certified Small Business located in a designated HUB-Zone area.

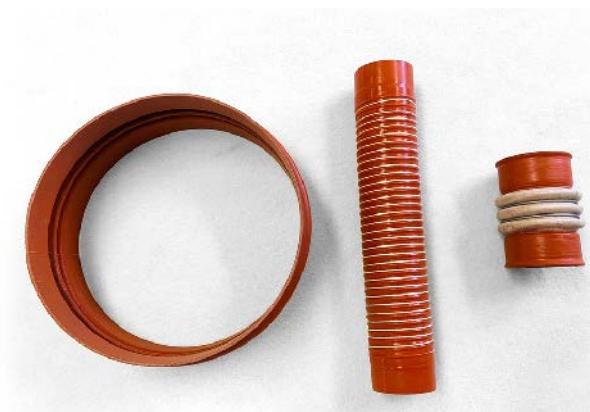

Fluid Systems

Air Supply



MANUFACTURER OF BAND CLAMPS, V-RETAINER COUPLINGS, DUCTING COMPONENTS AND AXIAL-LOAD BULGE FORMING

Voss Industries® has been consistently recognized for its manufacturing solutions at the global, national and regional levels.

As part of the Consolidated Aerospace Manufacturing, LLC group, **Voss Industries®** produces precision-engineered specialized band clamps, V-band couplings, flanges, ducting components, and a variety of other fabricated products for various industries.

The company's quality assurance programs comply with ISO 9001:2008, AS9100C, and CFR 14, Part 21. **Voss®** is also Nadcap-certified for welding, chemical processing, non-destructive testing, and fluid systems.

PERFECT SEAL, THE IDEAL CLAMPING SOLUTION FOR AIRCRAFT ENVIRONMENTAL CONTROL SYSTEMS (ECS) AND OTHER LOW PRESSURE APPLICATIONS





- Undamaged mating surfaces
- Quick release latching
- Superior Sealing Capability
- F.O.D. resistant design
- Light weight
- Superior alternative to NAS1922 and other similar clamps
- DFARS compliant possibility

*please inform your salesperson if DFARS compliant material is required.

PERFECT SEAL RESULTS IN VIRTUALLY NO DAMAGE TO CLAMPING SURFACE!

visible damage results from using NAS1922 clamp



typical application showing PERFECT SEAL vs. NAS1922 WORM GEAR CLAMP

CORRECTION FACTORS FOR MATERIAL WEIGHTS: Nickel 625: x 1.05
6-4 TITANIUM: x 0.95

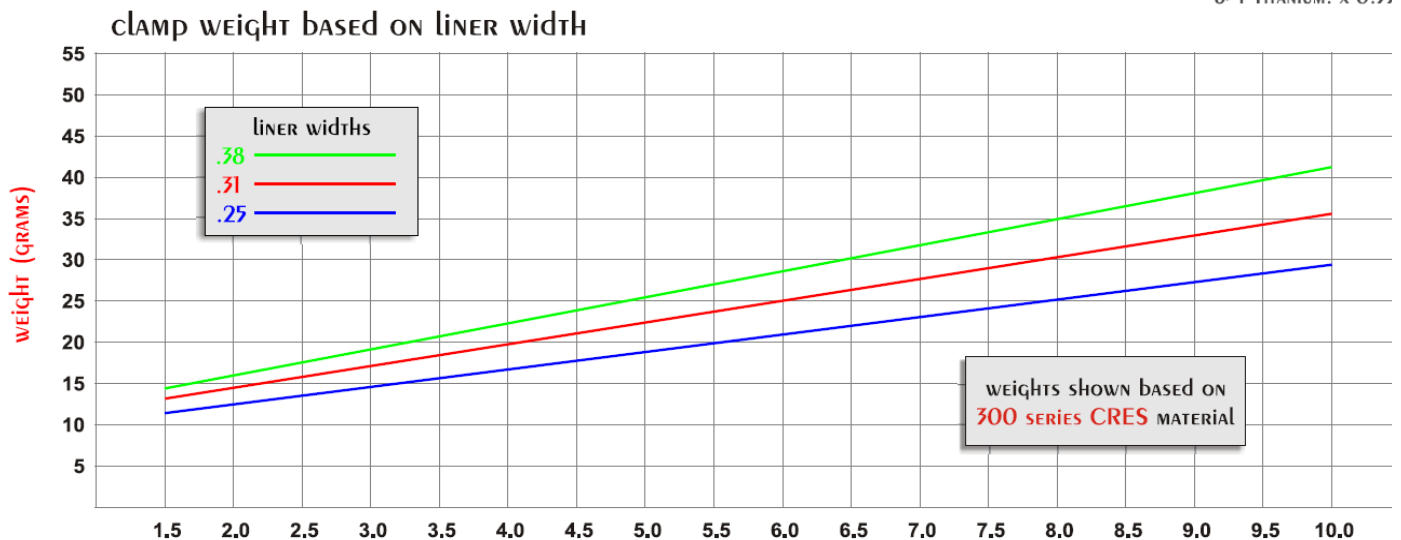

Motion Control

Seat & Screen motions



ADVANTEX

CONSTANT TORQUE FRICTION HINGES



Advantex HexaTorq torque-controlling hinges set a new benchmark for reliable and cost-effective motion control.

The range includes two families of friction hinges, providing a complete solution for various hinge requirements. These free-stop hinges combine innovative metal and high-performance plastic resin assemblies, ensuring exceptionally smooth movement.

Available in several standardized sizes, with or without integrated mounting brackets, they can be easily adapted to a wide variety of applications.

Design and durability tests show that in high-temperature or continuous cyclic conditions, torque may temporarily decrease but returns to its preset value after a short cooling period, without causing damage to surrounding components.

Thanks to a constant-torque design using advanced engineered resin, HexaTorq hinges require no lubrication.

Integrating the **Advantex HexaTorq** motion control hinge range can also significantly shorten the design-to-manufacturing cycle, helping companies reduce development time and overall costs.



INVISIBLE HINGES



APPLICATIONS

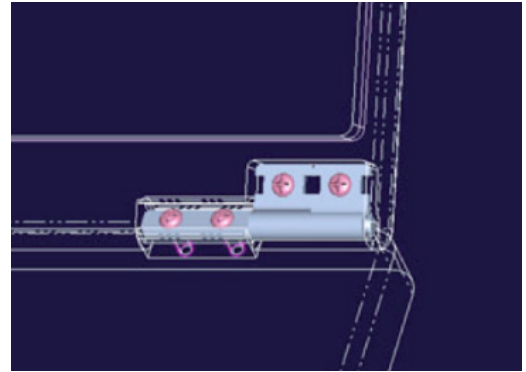
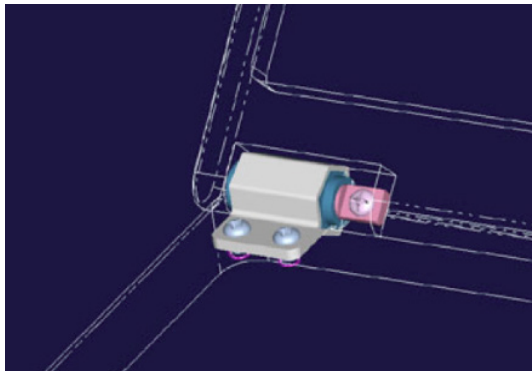

- Constant torque life : Designed for 30,000 flawless cycles
- Highly durable : almost no wear
- No spring return : holds position over entire range of motion
- Lightweight and compact
- Standard : 6 torque range and several mounting options
- Corrosion resistant : Stainless steel and resin material
- Easy mounting without brackets : Hexagonal configuration
- No FOD (foreign object damage) : No metal / metal contact, no particle
- Eliminates contamination or corrosion : no lubrication required



Motion Control

Seat motions



GAS SPRINGS & FITTINGS

The gas spring is a hydropneumatic control element composed of a rod, a tube, and appropriate end fittings at each end.

This device provides controlled assistance for opening and/or closing, with force and damping tailored to your environment and application.

BENEFITS

- Wide range of sizes, forces and fittings
- Easy and quick assembly
- Customizable to your application
- Many options available
- Large number of cycles
- Operating Temperature : -40°C à/to $+100^{\circ}\text{C}$



- Plastic guide
- More than 80 000 cycles with loss F1 < 10%
- DO160 T°C compliant (-55°C)

Vari-Lift valve can be fitted to all our gas springs :

- It converts a fixed force spring into an adjustable force version
- Adjusted to suit individual applications
- Can be adjusted in-situ saving both time & effort





- Wide range of end fittings (Nylon, Stainless steel and steel) : Ball joints, Eyes, Clevis forks
- 90° bracket with pin or ball pin or Slic Pin® or ball joint
- Flat bracket with pin or ball pin or Slic Pin® or ball joint

BLOCABLE GAS SPRINGS AND RELEASE SYSTEMS



VARI-LIFT

Force ajustement



SWIFT & SURE

Fixed force: constant force 10 to 10,000 N



ECONOLOC

Automatic locking



BLOCKLIFT

Internal locking mechanism



STOP & STAY

Multiposition gas spring with manual adjustment



STOP & STAY+

Pre-set multiposition gas spring

Motion Control

Seat motions & Cabine Storage



LIGHTWEIGHT AIRCRAFT INTERIOR SOLUTIONS

Jonathan Engineered Solutions® (JES), an AS9100-certified manufacturer, provides lightweight aluminum slide solutions for commercial aircraft, business jets, and general aviation.

These designs reduce aircraft weight, improve fuel efficiency, and lower noise, offering key advantages for design engineers. With years of experience with leading aircraft manufacturers, JES brings deep expertise in aerospace applications.



Excellence in Motion

CONCEALED SLIDE SOLUTION

ES280HTB / ES380TB

ES280HTB (Hybrid)
*Cycle Load: 80 Lbs. (36Kg)

ES380TB
Cycle Load: 200 Lbs. (90Kg)

Technical Information

Standard Lengths: 10" - 24" (254-610)
 Cycle Tested: 10,000 Min.
 *Load Tested to 100 lbs. Without Failure
 Travel: Equal to Slide Length
 Material: High Strength, Light Weight Aluminum Alloy - (ES380T)
 High Strength, Light Weight Aluminum Alloy & Stainless Steel - (ES280H)

Options:

- Change of Travel
- Rear Damping & Spring Tension Pre-Load
- Hole Pattern
- Polymer Ball Bearings
- Locks Open/Closed
- Self-Closing

EXECUTIVE STEALTH SLIDES

Concealed Undermount Design

ADVANTAGES

- Lightest products available (Min 20% Saving, it means drastic cost saving when penalties are estimated to 500\$/Kg)
- Quiet polymer ball bearings
- Smooth slide motion, excellent perception
- Executive black anodized finish
- Advantage weight savings
- Sound dampening
- Enhanced performance features
- Fully customizable features available

AIRCRAFT LINEAR MOVEMENT & ACCESS APPLICATIONS

Business Jet Applications :

- Seat Stowage
- Arm Rest
- Coffee Cup Holders
- Trash Bins
- Ice Drawers
- Liqueur Cabinets
- Door Partitions
- Others

Commercial Aircraft Applications :

- Emergency Stowage Compartments
- Leg Rests for Seats
- Sliding Seats Mechanisms
- Partitions
- Galleys
- In-Flight Entertainment Systems
- Others

POCKET DOOR SOLUTION

- ▶ *Reduced Weight*
- ▶ *Reduced Noise*
- ▶ *Fully Retractable Feature*



SEAT MOTION SOLUTION

- ▶ *High Cycle Life*
- ▶ *Light Weight, High Strength Aluminum*
- ▶ *Strong & Reliable*
- ▶ *Smooth, Quiet Linear Travel*



Fasteners

Aluminum seat structure



SELF LOCKING SYSTEM

Your issue:

- High number of assembly & disassembly cycles
- Loosening due to vibration, shock, temperature
- Galling, corrosion, electrical conductivity
- Additional locking systems: thread lock, spring washer, adhesive, pin



OUR SOLUTION: SELF-LOCKING THREAD SPIRALOCK®

- Single tapping with one 30° ramp
- Excellent shock, vibration and high temperature resistance without secondary locking system
- Better distribution of efforts on threading
- Compatible with standard screws
- CUC of high uses without loss of performance
- Eliminates other locking solutions
- Severely reduces galling
- Improves electrical conductivity



ADVANTAGES

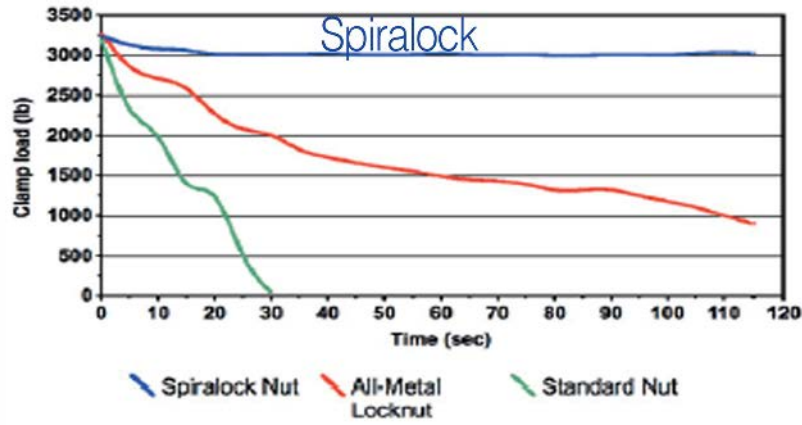

Removal of any secondary locking device : Washers, adhesives (patch, glue), pin

Reusable - Removable : Without cleaning

Optimization of the thread length : Gain time machining, material

Reduction of galling due the contact thread vs screw

No metal pollution due by friction

Electrical conduit : metal-to-metal contact

Note : The disassembling torque of a **Spirallock**[®] assembly is a lower right than a conventional 60° system.

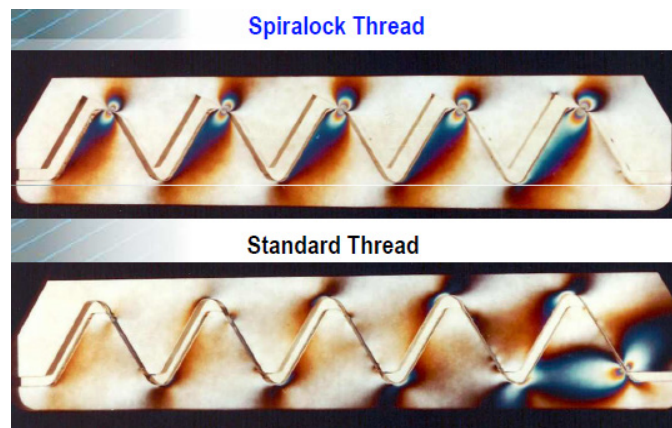
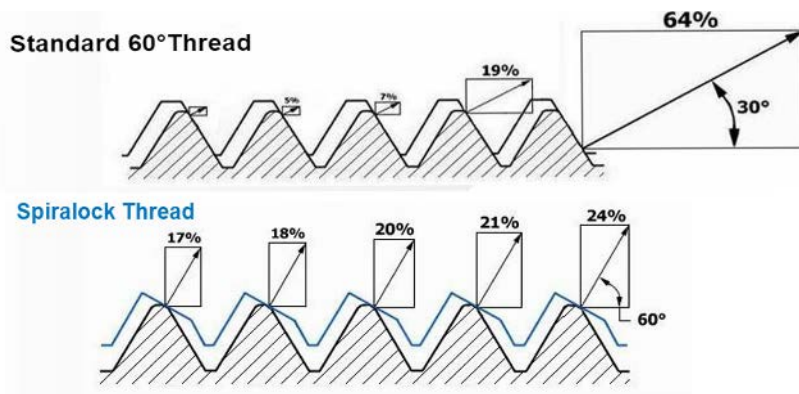

Fasteners

Aluminum seat structure



REPLACES 1 PC CARBIDE DESIGN AT 2/3 THE COST

The **Cutwell WAVE™ Drilling System** is the latest advancement in High Performance drilling for the Aerospace Composites Industry.

FEATURES :

- Drill & C'sink in CFRP & CFRP/Metallic Stacks
- Wave-Point® Diamond Coated Drill + PCD Insert
- 33% Savings over 1pc Drill & C'sink Drill
- 6 Week Delivery of Fully Customized Solutions
- Easy Modular Assembly
- Perfectly matched with MQL
- Robust Design
- Excellent runout - .0005" (13 µm) or less
- High Gripping force
- Dampens Vibration / Reduces Chatter

HOW IT WORKS

Solid carbide, CVD diamond coated Wave-Point® drill

Wave Holder connects the Wave-Point® Drill and custom PCD insert in a robust, easy to install system.

Standard Industry holder provides even and firm 360 deg clamping on Wave Holder and drill.

Wave-Point® Excels in Carbon Fiber

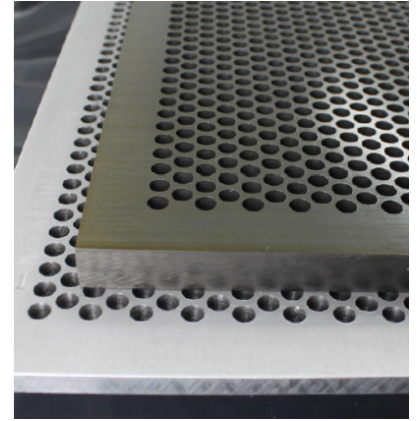

- Longest Drill Life
- Fastest Drilling Speed
- Lowest Cost/Hole

HIGH-PERFORMANCE DRILLS FOR AEROSPACE COMPOSITES

Eliminate exit delamination and burrs with patented Wave-Point® technology

Carbon fiber composites united with lightweight alloys create manufacturing challenges that affect cutting tool life and hole quality. Proven, patented Wave-Point® technology changes everything. It turns today's challenges into tomorrow's opportunities.

- Exclusive design carves composites and alloy stacks
- CVD diamond coatings maximize tool life
- Apply **Wave-Point®** technology to cutting tools from 1mm up to 36mm diameter
- Operate at highest feed and longest tool life in the industry without exit burrs or delamination
- Optimized, diamond-coated designs for stacks of CFRP/CFRP, CFRP/Alum and CFRP/Ti

Benchmark Test of Industry Leading CFRP Drills

6.35mm Dia Drill in 19mm thick Aerospace Structural Carbon Fiber Panels

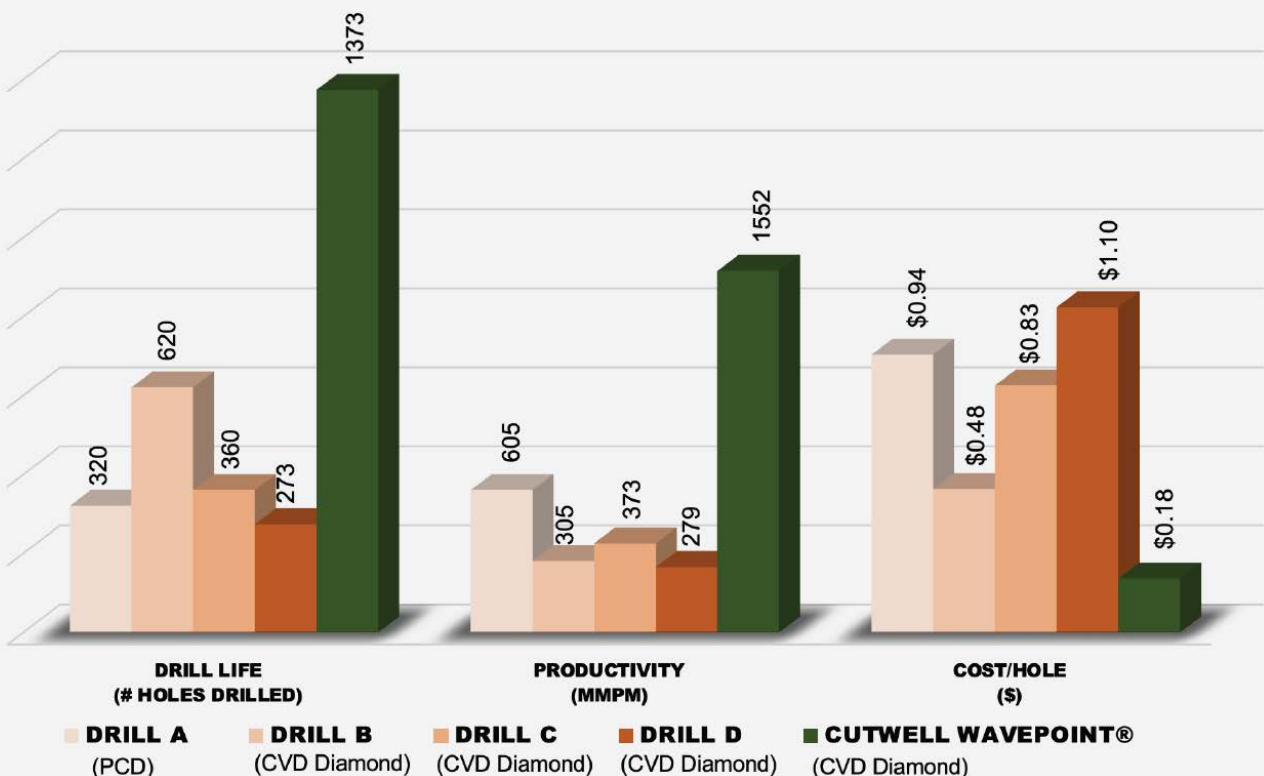

Fasteners

Aluminum seat structure



KATO

INSTALLATION PROCESS

Tangless[®] threaded nets have revolutionized the threaded net market, they respond exactly to the same characteristics as the conventional trainer version, without having to break, remove, or lose the trainer. Only the installation / removal method differs, in addition it is possible to readjust or remove the net after installation.

The unique notched shape of the ends of the **Tangless**[®] insert, combined with the spindle spring drive tool, allows a very quick and easy assembly / disassembly.

SCREW, UNSCREW, THE INSERT IS INSTALLED !

OPERATION

The claw is positioned in the notch of the insert and rotates it in the receiving part, once abutted or when the user decides, the change of direction of rotation causes the automatic release of the claw, thus allowing the extraction of tooling and positioning of the **Tangless**[®] insert net

Spring brushing tool

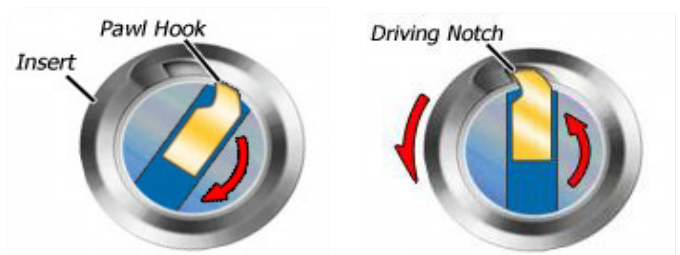
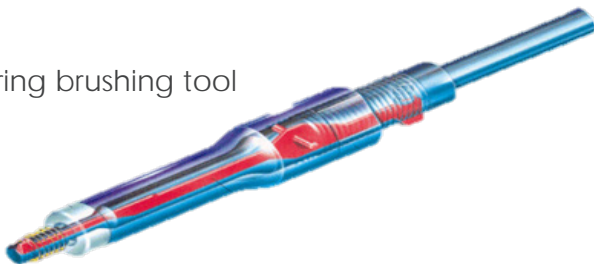

CHARACTERISTICS



Range

- Metric: not standard and fine (M / MJ), M2 to M12
- Poucique: (UNC / UNF / UNJ), 2-56 to 3 / 8-16
- Lengths: 1D to 3D



Standard or Locking Version:

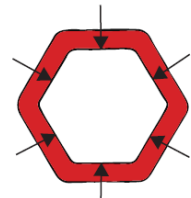

- The locking version provides a friction torque (prevailing torque, Hexagonal deformation of a turn) to loosen, given for 15 cycles of assembly / disassembly of the screw
- Perfect for applications subject to vibration or shock.

MATERIALS AND COATINGS



304 Stainless Steel
(standard)



Phosphor bronze



Inocel X- 750



Nitronic 60

PLATINGS AND COATINGS



Dry film lubricant



Electroless nickel



Silver



Passivation



Cadmium



Colour identifier

TOOLING



Taps and control gages for
3B / 2B, 4H / 5H class fit



Manual or Hex Drive Tools,
Spare Kit Spindle

TOOLING FOR PNEUMATIC OR ELECTRIC INSTALLATION

- Usable with **Tangless®** inserts and conventional to trainer
- Self-reversing function to save installation time
- Keyless chuck
- Clean and quiet, perfect for controlled environments
- Coil fixing system
- Linear arm with compensation system and rotating locking ring to prevent musculoskeletal disorders

CT5430 CORDLESS DRIVER

The CT5430 driver can install inserts 2-56 and M2.5 up to 1/4" and M6 all powered by a rechargeable lithium-ion battery. The CT5430 offers two installation options: the KATO Prewinder Electric (KPE) tool and the KATO Hex Electric (KHE) tool.

- Fast-charging lithium-ion battery
- Auto-reversing for reduced installation time
- 100% compatible with existing KATO Prewinder Electric tools (KPE Series)
- 100% compatible with existing KATO Hex Electric tools (KHE Series)
- Available for both Tangless and Tanged KATO Wire Thread Inserts



All of the **CT5430 driver** includes the battery charger and two lithium-ion batteries, so there are no separate part numbers to remember or purchase.



CRESCENT MANUFACTURING

A REPUTATION BUILT ON PRECISION, CAREFUL MONITORING
AND PERFORMANCE



The industries we serve demand nothing short of excellence.

That's why our commitment to excellence-providing better screw and fastener parts, better tooling, and better training has not wavered in 60 years.

We manufacture and supply fasteners and miniature screws to critical industries through a network of fastener distributors across the globe.

Stock and Custom Fasteners for :

- Aeronautics
- Aerospace
- Commercial Aviation
- Military Aviation



Air Force & Navy
Aeronautical



National
Aerospace

VERNATHERM BY VERNET

Vernatherm by Vernet® manufactures high-quality thermally activated controls for a wide range of industrial markets, with aerospace representing its largest and most specialized sector. A comprehensive portfolio of thermal management solutions is offered, including thermostatic valves, pressure relief valves, multi-function valves, and thermostatic actuators (wax motors).

These solutions are specifically designed for applications in the Aerospace & Defense industry. All products are engineered, machined, and assembled in a state-of-the-art manufacturing facility. With more than 85 years of experience in the design and production of thermal actuators and thermostats, Vernatherm has developed extensive expertise in thermal control technologies.

These thermal control systems are used in a large majority of commercial aircraft, military vehicles, and unmanned aerial systems. In addition to thermal control products, a wide range of machined aerospace manifolds is also provided.



Vernatherm by Vernet is dedicated to creating a more sustainable future for the aerospace industry.

Our focus on thermostatic controls not only ensures maximum efficiency, safety, and reduced carbon footprints, but also demonstrates our commitment to using innovative and environmentally conscious solutions.

We are proud to be leading the way in sustainable aerospace component manufacturing and will continue to seek new and improved methods to reduce our impact on the environment.



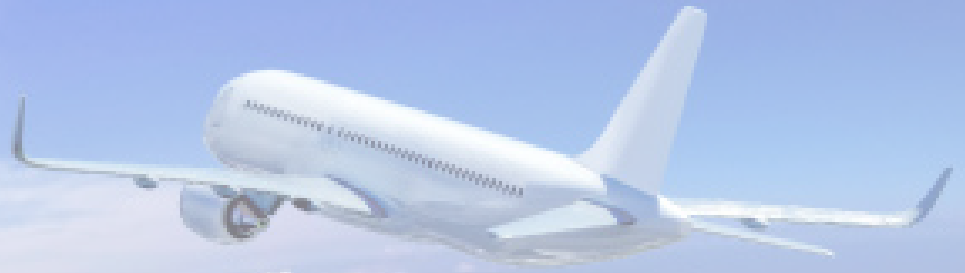

Jergens®

SPECIALITY FASTENERS : KWIK-LOK® PINS

Jergens Kwik-Lok® quick-release pins provide quick, easy positive engagement and high holding strength for applications requiring frequent, repetitive use. Heavy Duty & marine styles are also available. Our quality control procedures define the entire manufacturing process and provide complete traceability from raw materials tested in our metallurgical lab, to finished product. ISO 9001:2008 rated, QSLM approved, MS, NAS, DFARS and RoHS compliant parts available.

- Custom manufacturing
- Qualified according to NAS for aero/MS for the military
- Metric or imperial
- Certification of materials
- Tracability of batches on each spindle
- Complies with Reach, RoHS and DFARS standards
- Manufactured to AS9100 Rev D standards
- Special markings available
- Standard and custom lanyard options

JERGENS KWIK-LOK® PINS-STYLES



T-Handle

Jergens T-Handle Kwik-Lok® Pins provide a firm, even grip for smooth comfortable operation. The stainless steel construction and smart engineering of the pins resist corrosion in harsh environments. Experience quick, easy positive engagement and high holding strengths for applications requiring frequent, repetitive use.



L-Handle

Jergens L-Handle Kwik-Lok® Pins provide a firm grip for applications where a T-Handle will not fit. The stainless steel construction and smart engineering of the pins resist corrosion in harsh environments. Experience quick, easy positive engagement and high holding strengths for applications requiring frequent, repetitive use.



Button Handle

Jergens Kwik-Lok® Button Handle Pins are ideal for applications that have limited space around the handle. The stainless steel construction and smart engineering of the pins resist corrosion in harsh environments. Experience quick, easy positive engagement and high holding strengths for applications requiring frequent, repetitive use.



Ring Handle

Jergens Kwik-Lok® Ring Handle Pins are designed for applications which require small clearance area around the pin. The stainless steel construction and smart engineering of the pins resist corrosion in harsh environments. Experience quick, easy positive engagement and high holding strengths for applications requiring frequent, repetitive use.



Double Acting

Jergens Kwik-Lok® Double Acting Pins are ideal for quick insertion and removal and are activated by push or pull motion. The double-acting pins are available in T-Handle, L-Handle, and Ring Handle styles. The stainless steel construction and engineering resist corrosion in harsh environments. Experience quick, easy positive engagement and high holding strengths for applications requiring frequent, repetitive use.



Marine

Jergens Kwik-Lok® Marine Pins are most corrosive resistant pins for the most harsh, marine environments. Their stainless steel handles withstand tough environmental conditions.



Detent

Jergens Kwik-Lok® Detent Pins are high-quality shoulder-style alignment pins for applications that don't require the positive locking ball feature. Their heavy-duty spring and spring-loaded stainless steel locking balls provide high pull-out force. Their stainless steel construction and engineering resist corrosion in harsh environments. Experience quick, easy positive engagement and high holding strengths for applications requiring frequent, repetitive use.



Recessed Button Handle

Jergens Kwik-Lok® Recessed Button Handle Pin's design helps prevent accidental actuation of the pin. The stainless steel construction and smart engineering of the pins resist corrosion in harsh environments. Experience quick, easy positive engagement and high holding strengths for applications requiring frequent, repetitive use.



A series of horizontal dotted lines for writing, spanning the width of the page.



A series of horizontal dotted lines for writing, spanning the width of the page.

ENGINEERING



Since **1993**, more than **30 years** of expertise

Work differently - Work together

France



www.epciengineering.com

info@epcifrance.com

+33 1 34 48 34 10

United Kingdom



www.epciengineering.co.uk

info@epcifrance.com

+44 7 74 73 14 290



The specifications mentioned in this documentation are indicative and not contractual.

Although the contents of this documentation have been written with the utmost care, EPCI can not be held liable for any damage resulting from errors or omissions in this publication. In view of technological developments, EPCI also reserves the right to make technical modifications / replacements without notice. No rights can be derived from the contents of this document.